

# Audible and Visual Signalling Device

Series YL6S - Ex d, XENON / LED, GRP



E5



- Lamp: Flashing beacon – XENON (5 J) / LED (6.5 W)
- Horn: Omnidirectional / max. 110 dB(A)
- Type of protection: Ex d
- Class: IP66 (IEC 60529 / NEMA 4X)
- Corrosion-resistant GRP enclosure
- Stainless steel protection cage and mounting bracket included
- 8 light-intensifying Fresnel lens colours available to order
- 32 standardised preconfigured signal sounds (PFEER/UKOOA compatible)
- Individual signal sounds can be chosen (2 for AC versions, 3 for DC versions)
- Signal sound reduction up to 18 dB(A) adjustable
- Telephone system connection/line monitoring optionally available to order

WebCode **YL6SA**



**Product series YL6S** is designed to provide both an audible and visual alarm which can be used to alert, warn or draw attention to machine malfunction/start up or any number of safety related issues. The audible and visual signals can be operated independently or as a combination unit. Corrosion resistance is a key feature of the device which is ideally suited for applications in the harshest of environments both onshore and offshore.

	IECEX / ATEX					
Zone	0	1	2	20	21	22
Installation in		•	•		•	•

Selection Table						
Sound level Certificates	2 ATEX (BAS), IECEX (BAS)					
Lens colour	Rated operational voltage AC	Rated operational voltage DC	Rated operational current	Product Type	Art. No.	Weight kg
Amber	115 V	–	280 mA	YL6S/C-L-050-A-EN-SF-A-ST-00-00-00	225105	4.440
	230 V	–	115 mA	YL6S/C-N-050-A-EN-SF-A-ST-00-00-00	225113	4.440
Blue	115 V	–	280 mA	YL6S/C-L-050-B-EN-SF-A-ST-00-00-00	225106	4.440
	230 V	–	115 mA	YL6S/C-N-050-B-EN-SF-A-ST-00-00-00	225114	4.440
Clear	115 V	–	280 mA	YL6S/C-L-050-C-EN-SF-A-ST-00-00-00	225101	4.440
	230 V	–	115 mA	YL6S/C-N-050-C-EN-SF-A-ST-00-00-00	225109	4.440
Green	230 V	–	115 mA	YL6S/C-N-050-G-EN-SF-A-ST-00-00-00	225115	4.440
Red	115 V	–	280 mA	YL6S/C-L-050-R-EN-SF-A-ST-00-00-00	225104	4.440
	230 V	–	115 mA	YL6S/C-N-050-R-EN-SF-A-ST-00-00-00	225112	4.440
Yellow	115 V	–	280 mA	YL6S/C-L-050-Y-EN-SF-A-ST-00-00-00	225103	4.440
	230 V	–	115 mA	YL6S/C-N-050-Y-EN-SF-A-ST-00-00-00	225111	4.440

Selection Table						
Sound level Certificates		3 ATEX (BAS), IECEx (BAS)				
Lens colour	Rated operational voltage AC	Rated operational voltage DC	Rated operational current	Product Type	Art. No.	Weight kg
Amber	-	24 V	600 mA	YL6S/C-D-050-A-EN-SF-A-ST-00-00-00	225076	4.440
		48 V	420 mA	YL6S/C-F-050-A-EN-SF-A-ST-00-00-00	225087	4.440
Blue	-	24 V	600 mA	YL6S/C-D-050-B-EN-SF-A-ST-00-00-00	225078	4.440
Clear	-	24 V	600 mA	YL6S/C-D-050-C-EN-SF-A-ST-00-00-00	225072	4.440
		48 V	420 mA	YL6S/C-F-050-C-EN-SF-A-ST-00-00-00	225081	4.440
Green	-	24 V	600 mA	YL6S/C-D-050-G-EN-SF-A-ST-00-00-00	225079	4.440
Red	-	24 V	600 mA	YL6S/C-D-050-R-EN-SF-A-ST-00-00-00	225075	4.440
		48 V	420 mA	YL6S/C-F-050-R-EN-SF-A-ST-00-00-00	225086	4.440
Yellow	-	24 V	600 mA	YL6S/C-D-050-Y-EN-SF-A-ST-00-00-00	225074	4.000
		48 V	420 mA	YL6S/C-F-050-Y-EN-SF-A-ST-00-00-00	225084	4.440
Sound level Certificates		3 EAC (ENDCE), Russian Federation (TPB SER)				
Lens colour	Rated operational voltage AC	Rated operational voltage DC	Rated operational current	Product Type	Art. No.	Weight kg
Red	-	24 V	600 mA	YL6S/C-D-050-R-RU-SF-A-ST-00-00-00	262796	4.440
Yellow	-	24 V	600 mA	YL6S/C-D-050-Y-RU-SF-A-ST-00-00-00	277868	4.440
Sound level Certificates		4 ATEX (BVIS), IECEx (BVIS)				
Lens colour	Rated operational voltage AC	Rated operational voltage DC	Rated operational current	Product Type	Art. No.	Weight kg
Amber	-	21.1 – 24 V	650 mA	YL6S/21-D05000-AW0003-ST0000-0000	284524	4.440
		21.1 – 24 V	1500 mA	YL6S/21-DV0000-AW0003-ST0000-0000	284531	4.440
Red	-	21.1 – 24 V	650 mA	YL6S/21-D05000-RW0003-ST0000-0000	284525	4.440
		21.1 – 24 V	1500 mA	YL6S/21-DV0000-RR0003-ST0000-0000	284530	4.440
Yellow	-	21.1 – 24 V	650 mA	YL6S/21-D05000-YW0003-ST0000-0000	284526	4.440
		21.1 – 24 V	1500 mA	YL6S/21-DV0000-YW0003-ST0000-0000	284532	4.440

Additional gas group variants and local certifications are available; please use the selection table online at [r-stahl.com](http://r-stahl.com). WebCode YL6SA

Technical Data				
Variant	YL6S/21-DV0000 LED	YL6S/21-D05000 Xenon flash tubes	YL6S - EN Xenon flash tubes	YL6S/-/-/-/-RU Xenon flash tubes
Explosion Protection				
IECEx gas explosion protection	Ex db IIC T6/T4 Gb	Ex db IIC T6/T4 Gb	Ex d IIC T5/T4 Gb	Ex d IIC T5/T4 Gb
IECEx gas explosion protection 2			Ex d IIC T4 Gb	Ex d IIC T4 Gb
IECEx dust explosion protection	Ex tb IIIC T80 °C ... T100 °C Db	Ex tb IIIC T80 °C ... T100 °C Db	Ex tb IIIC T95 °C ... T110 °C Db	Ex tb IIIC T95 °C ... T110 °C Db
IECEx dust explosion protection 2			Ex tb IIIC T110 °C Db	Ex tb IIIC T110 °C Db

# Audible and Visual Signalling Device

Series YL6S - Ex d, XENON / LED, GRP

STAHL

E5







Technical Data				
Variant	YL6S/21-DV0000 LED	YL6S/21-D05000 Xenon flash tubes	YL6S - EN Xenon flash tubes	YL6S/-/-...-RU Xenon flash tubes
<b>Explosion Protection</b>				
ATEX gas explosion protection	Ⓔ II 2 G Ex db IIC T6/T4 Gb	Ⓔ II 2 G Ex db IIC T6/T4 Gb	Ⓔ II 2 G Ex d IIC T5/T4 Gb	Ⓔ II 2 G Ex d IIC T5/T4 Gb
ATEX gas explosion protection 2			Ⓔ II 2 G Ex d IIC T4 Gb	Ⓔ II 2 G Ex d IIC T4 Gb
ATEX dust explosion protection	Ⓔ II 2 D Ex tb IIIC T80 °C ... T100 °C Db	Ⓔ II 2 D Ex tb IIIC T80 °C ... T100 °C Db	Ⓔ II 2 D Ex tb IIIC T95 °C ... T110 °C Db	Ⓔ II 2 D Ex tb IIIC T95 °C ... T110 °C Db
ATEX dust explosion protection 2			Ⓔ II 2 D Ex tb IIIC T110 °C Db	Ⓔ II 2 D Ex tb IIIC T110 °C Db
EAC gas explosion protection				Ⓔ I Ex d IIC T* Gb
EAC dust explosion protection				Ⓔ Ex tb IIIC T* °C Db
<b>Electrical Data</b>				
Line monitoring	Yes	Yes	Yes	Yes
Tolerance	-10 – 10 %	-10 – 10 %	-10 – 10 %	-10 – 10 %
<b>Acoustic Data</b>				
Sound pressure level	max. 110 dB(A) @ 1 m	max. 110 dB(A) @ 1 m	max. 110 dB(A) @ 1 m	max. 110 dB(A) @ 1 m
Tone selection	Via DIL switch	Via DIL switch	Via DIL switch	Via DIL switch
Volume control	Max. -18 dB(A) adjustment	Max. -18 dB(A) adjustment	18 dB (A) adjustment	18 dB (A) adjustment
<b>Ambient Conditions</b>				
Ambient temperature	-60 °C ... +50 °C (T6) -60 °C ... +70 °C (T4)	-60 °C ... +50 °C (T6) -60 °C ... +70 °C (T4)	-60 °C ... +40 °C (T5) -60 °C ... +55 °C (T4)	-60 °C ... +40 °C (T5) -60 °C ... +55 °C (T4)
Operating temperature			-50 °C ... +55 °C	-50 °C ... +55 °C
<b>Lighting Data</b>				
Lamp	LED	Xenon flash tubes	Xenon flash tubes	Xenon flash tubes
Flashbulb		5 J	5 J	5 J
Flash rate	1 Hz 1.5 Hz 2 Hz Double flash 1 Hz Double flash 2 Hz Triple flash 1 Hz Triple flash 2 Hz	1 Hz	1 Hz	1 Hz
<b>Mechanical Data</b>				
IP degree of protection (IEC 60529)	IP66	IP66	IP66/IP67	IP66/IP67
Enclosure material	Polyester, Glass fibre reinforced	Polyester, Glass fibre reinforced	Polyester, Glass fibre reinforced	Polyester, Glass fibre reinforced
Trumpet material	ABS, flame retardant	ABS, flame retardant	ABS, flame retardant	ABS, flame retardant
Material dome	Polycarbonate, prismatic	Polycarbonate, prismatic	Polycarbonate, prismatic	Polycarbonate, prismatic
Wire guard material	Stainless steel	Stainless steel	Stainless steel	Stainless steel
Max. solid connection terminals	2.5 mm <sup>2</sup>	2.5 mm <sup>2</sup>	2.5 mm <sup>2</sup>	2.5 mm <sup>2</sup>
Max. finely stranded connection terminals	2.5 mm <sup>2</sup>	2.5 mm <sup>2</sup>	2.5 mm <sup>2</sup>	2.5 mm <sup>2</sup>
<b>Mounting / Installation</b>				
Mounting part material	Stainless steel	Stainless steel	Stainless steel	Stainless steel
<b>Components</b>				
Drilled holes	2 x M20	2 x M20	2 x M20	2 x M20
Stopping plugs	2 x dust cap	2 x dust cap	2 x dust cap	2 x dust cap

You can find more technical data online at [r-stahl.com](http://r-stahl.com). WebCode YL6SA

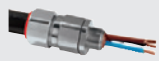

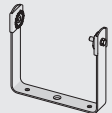

Accessories				
Figure	Description	Art. No.	Weight kg	
<b>Cable glands</b>				
	Ex e adapter for ATEX - 20 °C to +50/60 °C	264252	0.270	

3

**Accessories**

Figure	Description	Art. No.	Weight kg
<b>Cable glands made of metal</b>			
	Ex d & Ex e cable entry with compound for all types of armoured cables (SWA, braided, tape) (nickel-plated brass) Type 20PX2K, M20 x 1.5	109428 ▲	0.240
	Ex d & Ex e Cable entry with RapidEx sealing system for all types of unarmoured and braid armour cables (nickel-plated brass) Type 20PX2K-REX, M20 x 1.5	246649 ■	0.240
	Ex d & Ex e Cable entry with compound gland for all types of unarmoured and braid armour cables (nickel plated brass) Type 20PXSS2K, M20 x 1.5	109441 ▲	0.200
	Ex d & Ex e Cable entry with RapidEx sealing system for all types of unarmoured and braid armour cables (nickel-plated brass) Type 20PXSS2K-REX, M20 x 1.5	246605 ■	0.200
<b>Mounting accessories</b>			
	U-bracket, stainless steel	224587	0.450
	L-bracket, long, stainless steel (available for FL6S, FX15, YA60, YL6S, YA6S, YL60)	247371	0.280

**Spare Parts**

Figure	Description	Art. No.	Weight kg
<b>Assembly kit moulding horn</b>			
	Moulding horn YA60 / YL60 / YA6S / YL6S ATEX replacement	213457	0.105
<b>Flange</b>			
	Flange, ATEX, amber (available for FL6S, FX15, YL6S)	243407	1.190
	Flange, ATEX, blue (available for FL6S, FX15, YL6S)	243406	1.190
	Flange, ATEX, clear (available for FL6S, FX15, YL6S)	223578	1.190
	Flange, ATEX, green (available for FL6S, FX15, YL6S)	243405	1.190
	Flange, ATEX, red (available for FL6S, FX15, YL6S)	243408	1.190
	Flange, ATEX, yellow (available for FL6S, FX15, YL6S)	243409	1.190
<b>Fresnel lens</b>			
	Fresnel lens blue replacement	292141	0.180
	Fresnel lens red replacement	292147	0.180
<b>Lamp</b>			
	Xenon lamp (available for FL6S, FX15, YL6S)	223636	0.006
<b>PCB</b>			
	Connection PCB (available for FL6S, FX15, YL6S)	223579	0.020

## Spare Parts

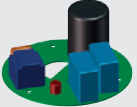
Figure	Description	Art. No.	Weight kg
<b>PCB</b>			
	Electronic PCB, 115 V AC, 5 J (available for FL6S, FX15, YL6S)	223632	0.118
	Electronic PCB, 230 V AC, 5 J (available for FL6S, FX15, YL6S)	223580	0.100
	Electronic PCB, 24 V DC, 5 J (available for FL6S, FX15, YL6S)	223635	0.080

A lens wire guard (VA) and bracket (VA) are supplied as standard.

## Dimensional Drawings (All Dimensions in mm [inches]) – Subject to Alterations

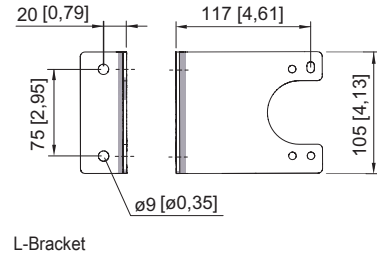
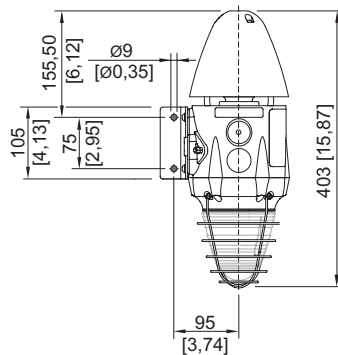
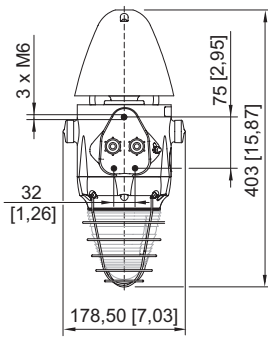

GRP  
Combination Signal Series YL6S without L-Bracket

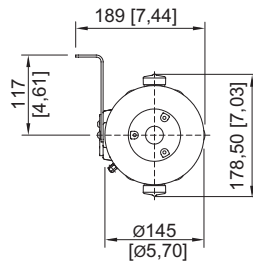

GRP Combination Signal Series YL6S with L-Bracket