



- Robust, seawater resistant aluminium enclosure
- Flashing frequency 1 Hz
- Flashing energy 5 Joules
- Integrated Ex e connection chamber
- Light dome available in: signal yellow, red, orange, green, blue and clear
- Steady beacon in LED technology
- Extreme temperature range -40 ... +50 °C

E5

WebCode **6161A**



The flashing beacons and steady beacons of Series 6161 are installed to provide optical signals in explosive gas atmospheres and areas with combustible dust.

	ATEX / IECEx					
Zone	0	1	2	20	21	22
Installation in		•	•		•	•

Selection Table							
Lamp		Flash tubes					
Rated operational voltage AC	Rated operational voltage DC	Nominal current	Lens colour	Product Type	Art. No.	PS	Weight kg
24 – 42 V	12 – 48 V	0.3 – 0.5 A	Yellow	6161/2-61-121-0	120674	34	1.400
		0.3 – 0.5 A	Clear	6161/2-61-221-0	219802	34	1.400
		0.3 – 0.5 A	Red	6161/2-61-321-0	120668	34	1.400
		0.3 – 0.5 A	Blue	6161/2-61-421-0	219803	34	1.400
		0.3 – 0.5 A	Green	6161/2-61-521-0	263357	34	1.400
		0.3 – 0.5 A	Orange	6161/2-61-621-0	120680	34	1.310
		110 – 127 V	-	0.11 – 0.11 A	Yellow	6161/2-31-121-0	219805
0.11 – 0.11 A	Clear			6161/2-31-221-0	219806	34	1.400
0.11 – 0.11 A	Red			6161/2-31-321-0	219807	34	1.400
0.11 – 0.11 A	Blue			6161/2-31-421-0	219808	34	1.400
0.11 – 0.11 A	Green			6161/2-31-521-0	219810	34	1.400
0.11 – 0.11 A	Orange			6161/2-31-621-0	219809	34	1.400
230 – 230 V	-			0.08 – 0.08 A	Yellow	6161/2-11-121-0	120648
		0.08 – 0.08 A	Clear	6161/2-11-221-0	219249	34	1.400
		0.08 – 0.08 A	Red	6161/2-11-321-0	120655	34	1.400
		0.08 – 0.08 A	Blue	6161/2-11-421-0	219250	34	1.400
		0.08 – 0.08 A	Green	6161/2-11-521-0	219801	34	1.400
		0.08 – 0.08 A	Orange	6161/2-11-621-0	120662	34	1.400

Selection Table

Lamp		Flash tubes					
Rated operational voltage AC	Rated operational voltage DC	Nominal current	Lens colour	Product Type	Art. No.	PS	Weight kg
-	60 – 80 V	0.11 – 0.13 A	Yellow	6161/2-41-121-0	219813	34	1.400
		0.11 – 0.13 A	Clear	6161/2-41-221-0	219814	34	1.400
		0.11 – 0.13 A	Red	6161/2-41-321-0	219815	34	1.400
		0.11 – 0.13 A	Blue	6161/2-41-421-0	219816	34	1.400
		0.11 – 0.13 A	Green	6161/2-41-521-0	219819	34	1.400
		0.11 – 0.13 A	Orange	6161/2-41-621-0	219817	34	1.400
Lamp		LED					
Rated operational voltage AC	Rated operational voltage DC	Nominal current	Lens colour	Product Type	Art. No.	PS	Weight kg
24 – 24 V	24 – 24 V	0.12 – 0.12 A	Yellow	6161/3-70-121-0	219845	34	1.400
		0.12 – 0.12 A	Clear	6161/3-70-221-0	219846	34	1.400
		0.12 – 0.12 A	Red	6161/3-70-321-0	219847	34	1.400
		0.12 – 0.12 A	Blue	6161/3-70-421-0	219848	34	1.400
		0.12 – 0.12 A	Green	6161/3-70-521-0	219850	34	1.400
		0.12 – 0.12 A	Orange	6161/3-70-621-0	219849	34	1.400
230 – 230 V	-	0.02 – 0.02 A	Yellow	6161/3-10-121-0	219822	34	1.400
		0.02 – 0.02 A	Clear	6161/3-10-221-0	219828	34	1.400
		0.02 – 0.02 A	Red	6161/3-10-321-0	219831	34	1.400
		0.02 – 0.02 A	Blue	6161/3-10-421-0	219832	34	1.400
		0.02 – 0.02 A	Green	6161/3-10-521-0	219844	34	1.400
		0.02 – 0.02 A	Orange	6161/3-10-621-0	219842	34	1.400

Technical Data
Explosion Protection

Ambient temperature °C	-40 ... +40 °C
Gas explosion protection IECEx	Ex de IIC T6 Gb
Gas explosion protection ATEX	Ⓔ II 2 G Ex de IIC T6 Gb
Gas explosion protection EAC	1 Ex d e IIC T6...T5 Gb X
Dust explosion protection IECEx	Ex tb IIIC T85 °C Db
Dust explosion protection ATEX	Ⓔ II 2 D Ex tb IIIC T85 °C Db
Dust explosion protection EAC	Ex tb IIIC T65 °C...T100 °C Db X
Certificates	ATEX (LCI), China (CQST), EAC (TehnoP), IECEx (LCI), India (PESO), Korea (KTL)
Ship approval	GL





Electrical Data

Back-up fuse	4 AT
--------------	------

Mechanical Data

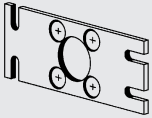
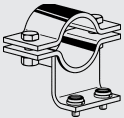
Degree of protection IP (IEC 60529)	IP66
Enclosure material	Aluminium, powder-coated, Seawater-resistant
Enclosure colour	Yellow / black, powder-coated
Sealing material	NBR O-ring seal
Material mounting parts	Stainless steel
Material dome	Polycarbonate (Lexan) Prismatic
Terminal marking	PE + N + L1
Connection terminals solid max.	4 mm ²
Connection terminals finely-stranded max.	2.5 mm ²

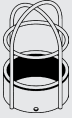
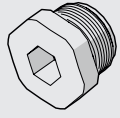
Technical Data	
Mounting / Installation	
Connection type	Screw terminals, 3-pin
Components	
Drilled holes	2 x M20
Screw connections	1 x M20 Ø 4 – 13 mm
Material of screw connections	Polyamide, black
Stopping plug	1 x M20 x 1.5
Stopping plug material	Polyamide, black
You can find more technical data online at r-stahl.com. WebCode 6161A	

Accessories and Spare Parts			
Figure	Description	Art. No.	Weight kg
Mounting plate			
	material: stainless steel, includes mounting screws, for wall or floor mounting	120821 ▲	0.158
Pipe clamp			
	R 1 1/4"	120812	0.500
	R 1 1/2"	120819	0.470
	R 2"	120823	0.500
Ceiling and wallmounting bracket			
	material: stainless steel includes mounting screws	120826 ▲	0.480
Wire guard			
	material: stainless steel	120818 ▲	0.260
Stopping plug			
	8290/3-M20, 1 piece	143522	0.005
	8290/3-M20, 100 pieces	143543 ▲	0.500
Cable gland			
	8161/7-M20-1304 4 ... 13 mm², 50 pieces (delivery lot')	239156 ▲	0.013

* Purchase order quantity in [pieces], the delivery quantity is automatically rounded to the delivery lot.

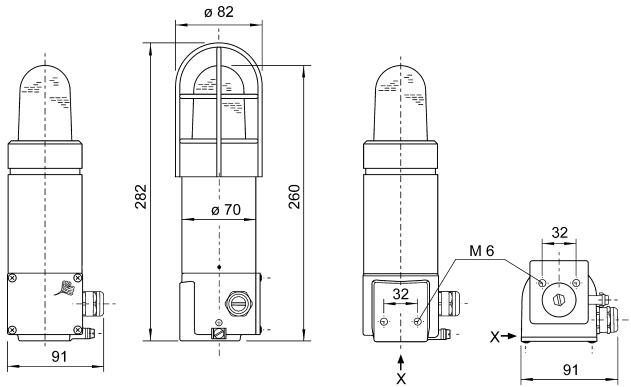

Optical beacon 6161

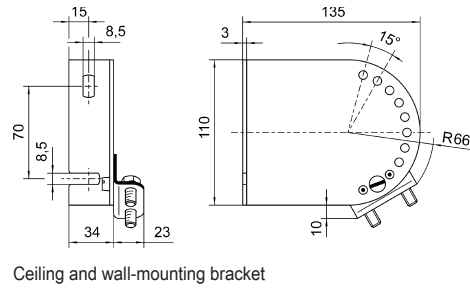

Ceiling and wall-mounting bracket

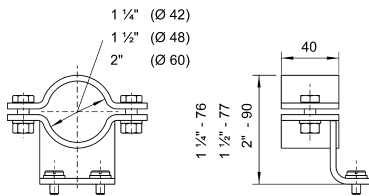

Pipe clamp

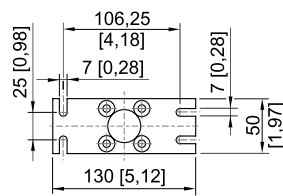

Mounting plate